

 **REAL-EL**

**OPERATION MANUAL**



**2.0 USB MULTIMEDIA  
SPEAKER SYSTEM**

**S-60**

***Congratulations on your purchase of the TM REAL-EL speaker system!***

Please read this Operation Manual before using the unit and retain this Operation Manual in a safe place for future reference.

**COPYRIGHT**

© 2016. ENEL GROUP OU.

This manual and information contained in it are copyrighted. All rights reserved.

**TRADEMARKS**

All trademarks are the property of their legal holders.

**NOTICE OF RESPONSIBILITY RESTRICTION**

Despite the exerted efforts to make this Manual more exact, some discrepancies may occur. The information in this Manual is given on “as is” terms. The author and the publisher do not bear any liability to a person or an organization for loss or damage, which has arisen from the information contained in this Manual.

**CONTENTS**

<b>1. BUYER RECOMMENDATIONS</b> .....	<b>1</b>
<b>2. PACKAGE CONTENTS</b> .....	<b>2</b>
<b>3. SAFETY PRECAUTIONS</b> .....	<b>2</b>
<b>4. TECHNICAL DESCRIPTION</b> .....	<b>2</b>
<b>5. PREPARATION AND OPERATION</b> .....	<b>3</b>
<b>6. TROUBLESHOOTING</b> .....	<b>4</b>
<b>7. TECHNICAL SPECIFICATIONS</b> .....	<b>4</b>

**BUYER RECOMMENDATIONS**

- Unpack the device carefully. Make sure there are no accessories left in the box. Check up the device for damage; if the product was damaged during transportation, address the firm, which carried out the delivery; if the product functions incorrectly, address the dealer at once.
- Check up the package contents and availability of the warranty card. Make sure the warranty card has a shop stamp, a legible signature or the seller’s stamp and purchase date, and the goods number corresponds to that in the warranty card. Remember that at the loss of warranty card or lack of coincidence of numbers you are deprived the right on warranty repair.
- Do not switch on the product immediately after you bring it into a room from environment with negative temperature! After unpacking, the product should be kept in conditions of room temperature for at least 4 hours.

2. PACKAGE CONTENTS

- Speaker System — 1 pc
- User’s manual — 1 pc
- Warranty card — 1 pc

3. SAFETY PRECAUTIONS

- Do not open the multimedia speaker system (MSS) and do not perform repairs by yourself. Service and repairs should be performed only by qualified specialists at authorized service centers. The list of authorized service centers is on [www.real-el.com](http://www.real-el.com)
- Make sure that foreign objects do not get inside the holes of the MSS.
- Protect the MSS from high humidity, water and dust.
- Protect the MSS from heating: do not place it closer than 1 m from a heat source. Do not expose it to direct sunlight.
- Do not use any chemical agents for cleaning. Clean it with dry soft cloth only.
- If the MSS does not operate, unplug USB cable it and address your dealer.

4. TECHNICAL DESCRIPTION

S-60 2.0 USB Multimedia Speaker System is an easy and reasonable solution for your computer sound. The MSS has a built-in amplifier, an audio cable and a signal cable enabling to connect it to virtually any audio source. The MSS is powered via a PC or laptop USB port or a 5V DC power supply by means of the integrated USB cable.

MSS special features

- Passive emitter on the rear panel
- Enhanced sound system
- Compatibility with PC, notebooks, mobile devices and other sound sources
- USB power 5V DC (from a notebook, PC or power unit)
- Compact design
- Volume wheel on the cable

Rear panels

- ① Passive emitter
- ② Volume wheel
- ③ Bult-in signal cable
- ④ Bult-in USB cable
- ⑤ Bult-in audio cable

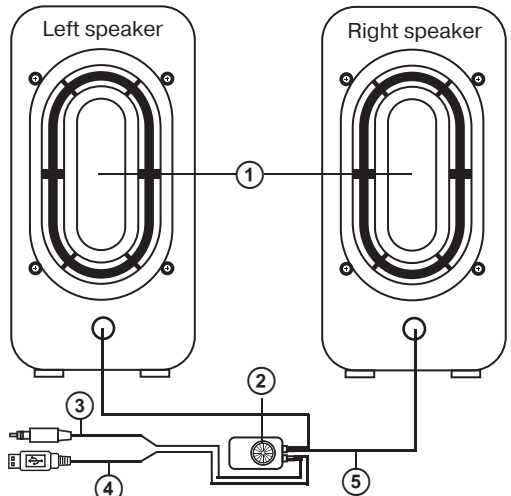

Fig. 1. Rear panels of speakers

S-60 speaker system is equipped with a passive emitter ①. The main advantage of a passive emitter is its ability to reproduce low frequencies with minimum distortions and with a higher sound pressure level than in case conventional phase inverters are used (see Fig. 2).

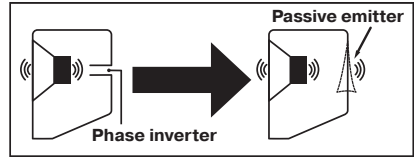

Fig. 2. Passive emitter operation principle

## 5. PREPARATION AND OPERATION

### Speaker placement

- Place the speakers symmetrically to the listener at least one meter away.
- Place MSS far away from monitors and TV sets, as insignificant image distortion in these supersensitive devices is possible.

### MSS Connecting

S-60 Multimedia Speaker System (MSS) can be connected to USB port on your computer or laptop (see connection diagram, Fig. 3).

- Plug USB cable ④ to the USB port on your computer or laptop.
- Plug signal cable mini jack ③ to PC sound card or to audio output of the audio source.
- Adjust speaker volume level by Windows tools or using volume wheel ② on the signal cable at your own discretion.
- Please unplug MSS USB cable ④ after shutting down your laptop or PC.

**Note: Connect the speakers to USB port of your laptop or PC otherwise please use active USB-hub.**

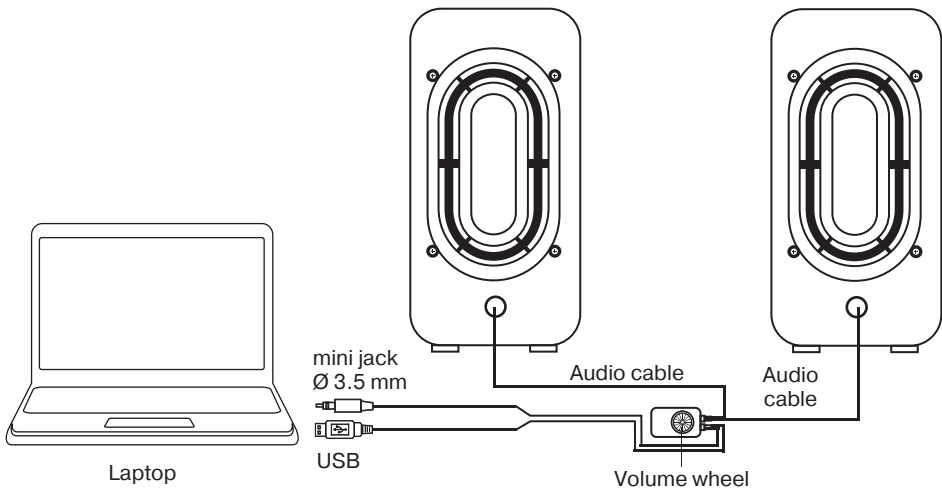

Fig. 3. Connection diagram

**6. TROUBLESHOOTING**

<b>Problem</b>	<b>Cause</b>	<b>Solution</b>
The MSS does not turn on.	The MSS isn't connected to a USB port.	Check the connection.
No sound or sound of speakers is too quiet.	Volume level is set at its minimum value.	Adjust the volume control knob.
	Improperly connected audio source.	Connect audio sources correctly.
Distortion of sound.	Large amplitude of the input signal.	Turn down the source volume and the MSS volume.

**Attention!** *If none of the above methods can solve the problem, please seek professional advice at your nearest service center. Never attempt to repair the product yourself.*

**7. TECHNICAL SPECIFICATIONS**

<b>Parameter, measurement unit</b>	<b>Value</b>
Output power (RMS), W	6 (3 + 3)
Frequency range, Hz	100 – 19,000
Speaker dimensions, mm	Ø 45
Passive emitter dimensions, mm	75 × 35
Power supply	USB / 5V DC
Case material	plastic
Dimensions (one speaker), mm	135 × 70 × 73
Weight, g	532

**Notes:**

- **Technical specifications given in this table are supplemental information and cannot give occasion to claims.**
- **Technical specifications and package contents are subject to change without notice due to the improvement of REAL-EL production.**



Models: **S-60**

Manufacturer: ENEL GROUP OU, Katusepapi tn 6, Lasnamäe linnaosa, Tallinn, Harju maakond, 11412, Estonia. Made in China.

© **Registered Trademark of ENEL GROUP OU. Estonia.**